

Client _____ Quantity _____
Project _____ Position _____

FUN 700

Model: F70/40FRESE/1V10/T

Cod: MP01292123001



Technical data

Modularity:	Top
Dimension (mm):	400x700x300
Total electric power (kW):	7,5
Nr. Wells:	1
Well litres 1:	10
Well dimensions 1 (mm):	244x364x207
Electric power (V):	380-415
Ampere (A):	11,5
Phases:	3N
Cable section (mmq):	5G2,5
Frequency (Hz):	50-60
Net volume (m3):	0,084
Packing dimensions (mm):	477x776x612
Gross weight (kg):	34
Gross volume (m3):	0,227

Features

Working top:	Made of AISI 304 stainless steel with a thickness of 10/10 mm
Type of heating:	Direct
Knobs:	Knobs are made from a sturdy heat-resistant polymer blend and are equipped with liquid anti-leakage washer
Heating:	Tilting heating elements for efficient cleaning

Electric fryer model top, eco version. 1 bowl capacity 10 lt top version. Top and bowl in AISI 304 stainless steel; covering in AISI 304 stainless steel thickness 8/10; external reinforcements made of anti-corrosion material (aluminised sheet metal); bottoms and internal parts in AISI 430 steel; flue cover in enamelled steel. Drain valve located in the lower neutral compartment. Equipped with drip tray for collection of residual oil included. Shielded heating elements can be turned over for cleaning, thermostat-controlled in a range of use from 100° to 190°C. Main switch, safety thermostat and indicator light to show correct operation. Vat dimensions: 370x250x210h. mm. Tub capacity 10 lt. - 1 basket with handle in thermoplastic material, 1 vat cover and 1 vat filter included. Total power 7.5 kW Electrical power supply VAC 400 + 3N 50 Hz.

Technical draw

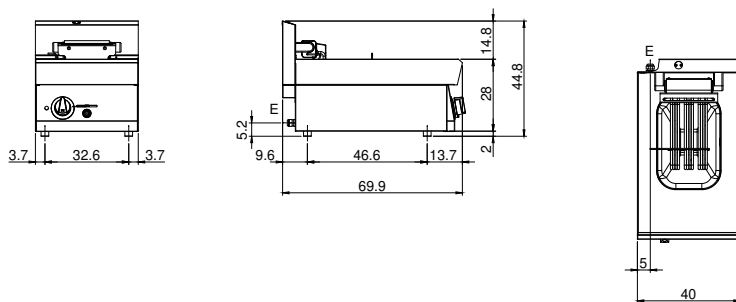

E: Electric power