



Client _____ Quantity _____

Project _____ Position _____

FUN 700

Model: F70/80PVE/P

Cod: MP01092123006

Technical data

Modularity:	On cabinet with doors
Dimension (mm):	800x700x850
Total electric power (kW):	10
Electric power (V):	380-415
Ampere (A):	23
Phases:	3N
Cable section (mmq):	5G4
Frequency (Hz):	50-60
Net volume (m3):	0,17
Packing dimensions (mm):	880x856x1274
Gross weight (kg):	56
Gross volume (m3):	0,960

Features

Working top:	Made of AISI 304 stainless steel with a thickness of 10/10 mm
Knobs:	Knobs are made from a sturdy heat-resistant polymer blend and are equipped with liquid anti-leakage washer
Handles:	Brushed aluminum finish

Electric pyroceram hob cabinet with door. Top made of AISI 304 stainless steel thickness 8/10; covering in AISI 304 stainless steel thickness 8/10; bottoms and internal parts in AISI 430 steel; internal reinforcements made of anti-corrosion material (aluminised sheet metal). Spacious hermetic hob, easy to clean, featuring independent cooking zones and gradual temperature adjustment. The cooking zones are highly flexible. They reach operating temperature quickly and are equipped with a device against overheating. 2 plates x 2.1 kW and 2 plates x 2.5 kW. Total power 9.2 kW. Electrical power supply VAC 400 + 3N 50÷60 Hz.

Technical draw

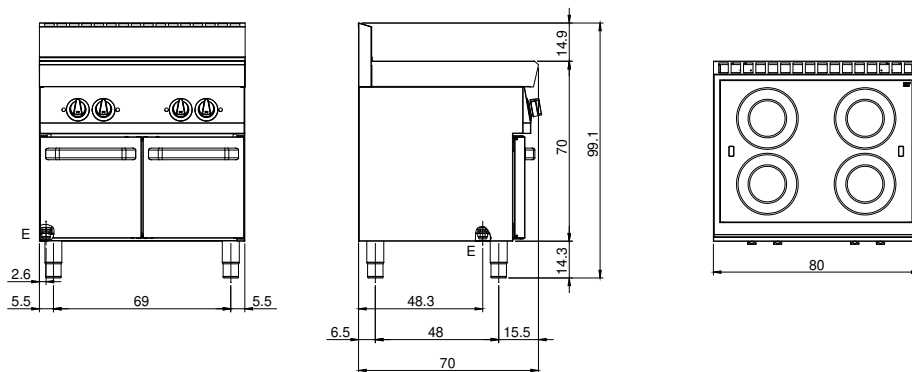

E: Electric power