

Client

Quantity

Project

Position

FUN 700

Model: F70/70TPPGFB/A

Cod: MP01052113004



Gas solid top range with 2 gas boiling unit on open cabinet. Top in AISI 304 stainless steel thickness 8/10; covering in AISI 304 stainless steel thickness 8/10; bottoms and internal parts in AISI 430 steel; internal reinforcements made of anti-corrosion material (aluminised sheet metal). Full plate in steel featuring high-performance differentiated thermal zones and equipped with extractable central ring. Heating takes place by means of the high-power cast iron central burner, with piezoelectric ignition pilot burner. Gas is supplied by means of a thermocouple safety valve. Hob with two high-power cast iron/brass rapid burners with pilot burner for automatic ignition. Gas is supplied by means of a safety valve with thermocouple. The enamelled steel bowl can easily be extracted for cleaning. The hob pan support is made of anti-acid enamelled cast iron. Full plate 1 burner 5.5 kW. Gas hob 2 burners 1 burner x 3.7 kW and 1 x 5.5 kW. Total gas power 14.7 kW.

Technical draw

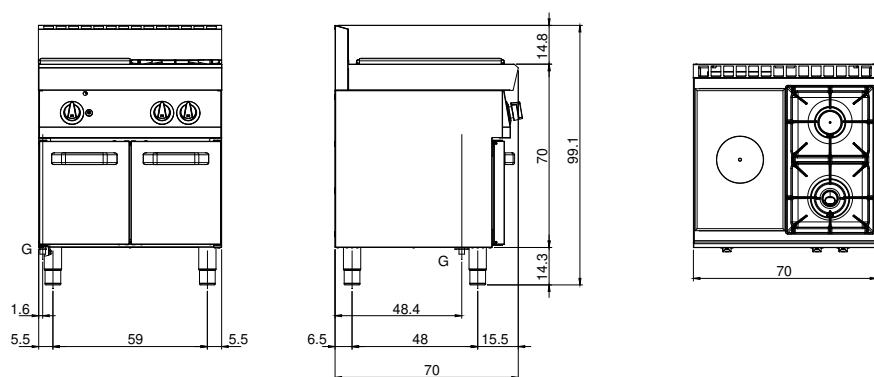

G: Gas connection 1/2"