



Client _____ Quantity _____
Project _____ Position _____

FUN 650

Model: F65/110CFGEB

Cod: MP01032132001

Technical data

| | |
|------------------------------|--------------------------|
| Modularity: | Electric oven |
| Dimension (mm): | 1100x650x850 |
| Oven dimension (mm): | 565x330x325 |
| Total electric power (kW): | 3,96 |
| Total gas power (Kcal/h): | 22184 |
| Total gas power (kW): | 25,8 |
| Oven type: | Electric convection oven |
| Oven power (kW): | 3,96 |
| Oven temperature range (°C): | 50-300 |
| Gas connection: | 1/2" |
| Electric power (V): | 380-415 |
| Ampere (A): | 6,5 |
| Phases: | 3N |
| Cable section (mmq): | 5G1,5 |
| Frequency (Hz): | 50 |
| Net volume (m3): | 0,608 |
| Packing dimensions (mm): | 1176x776x1180 |
| Gross weight (kg): | 115 |
| Burner power 1 (kW): | 5 |
| Burner power 2 (kW): | 3,6 |
| Burner power 3 (kW): | 5 |
| Burner power 4 (kW): | 3,6 |
| Burner power 5 (kW): | 5 |
| Burner power 6 (kW): | 3,6 |
| Gross volume (m3): | 1,077 |

Features

| | |
|--------------|--|
| Burners: | Piezo ignition available in cast iron with single crown brass burner cap |
| Grill: | In cast iron with long spokes |
| Working top: | Made of AISI 304 stainless steel with a thickness of 10/10 mm and removable enamelled containers |
| Knobs: | Knobs are made from a sturdy heat-resistant polymer blend and are equipped with liquid anti-leakage washer |
| Handles: | Brushed aluminum finish |
| Kit Gas: | Natural gas conversion kit 30/50 m/bar (tested with natural gas G20) |

Gas range, 6 burners with electric convection oven Top in AISI 304 stainless steel thickness 8/10; covering in AISI 430 stainless steel 8/10; bottoms and internal parts in AISI 430 steel; internal reinforcements made of anti-corrosion material. (aluminised sheet metal). Hob equipped with 6 burners (3x3.6 kW + 3x5 kW) - total power 25.8 kW. Bowls in enamelled steel that can be extracted for easy cleaning. Pan supports for hobs in acid-resistant enamelled cast iron Safety gas valve cocks with thermocouple. Piezoelectric burner ignition Internal oven dimensions 53x34x32,5h. Possibility for 3 pans GN 1/1 h. 6.5 cm. Thermal insulation of oven chamber and door. Forced convection electrical oven. Motor 0.18 kW. Fan rotor in stainless steel. 3 heating elements x 1.26 kW ea. Electric oven total power 3.78 kW. Main switch. Thermostat adjustable from 100° to 300° C. Indicator lights to show electrical power supplied and heating elements in operation. Total power 25.8 kW Total power 3.96 kW Electrical power supply V AC 400+3N 50÷60 Hz.

Technical draw

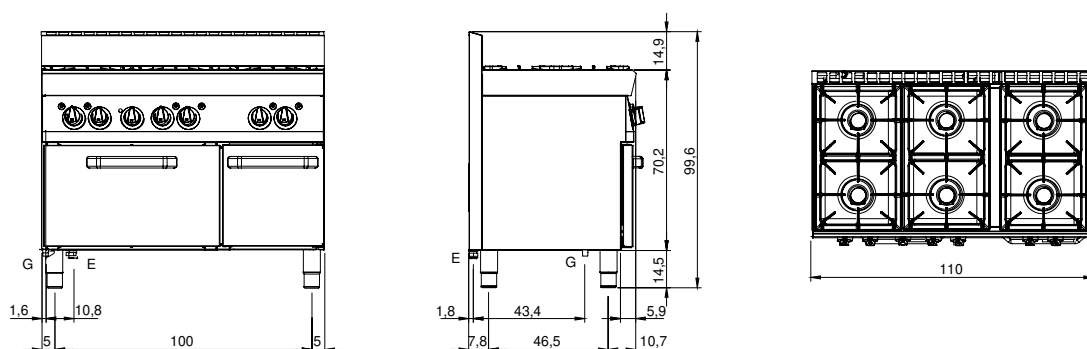

G: Gas connection 1/2"

E: Electric power