

Client \_\_\_\_\_ Quantity \_\_\_\_\_  
 Project \_\_\_\_\_ Position \_\_\_\_\_

## FUN 650

Model: F65/40PCGB/1F/T

Cod: MP01012112001



### Technical data

Modularity:	Top
Dimension (mm):	400x650x300
Total gas power (Kcal/h):	6449
Total gas power (kW):	7,5
Gas connection:	1/2"
Net volume (m3):	0,078
Packing dimensions (mm):	477x776x612
Gross weight (kg):	26
Burner power 1 (kW):	7,5
Gross volume (m3):	0,227

### Features

Burners:	Piezo ignition available in cast iron with single crown brass burner cap
Grill:	In cast iron with long spokes
Working top:	Made of AISI 304 stainless steel with a thickness of 10/10 mm and removable enamelled containers
Knobs:	Knobs are made from a sturdy heat-resistant polymer blend and are equipped with liquid anti-leakage washer
Kit Gas:	Natural gas conversion kit 30/50 m/bar (tested with natural gas G20)

Gas boiling unit, 1 burner (with pilot burner). Top in AISI 304 stainless steel thickness 8/10; covering in AISI 430 stainless steel 8/10; bottoms and internal parts in AISI 430 steel; internal reinforcements made of anti-corrosion material. (aluminised sheet metal). Hob equipped with high-power rapid burners in cast iron/brass (7.5 kW). Bowls in enamelled steel that can be extracted for easy cleaning. Pan support for hobs in acid-resistant enamelled cast iron Gas supplied by means of safety valve cocks with thermocouple and pilot burner for automatic burner lighting. Total power 7.5 kW

**Technical draw**

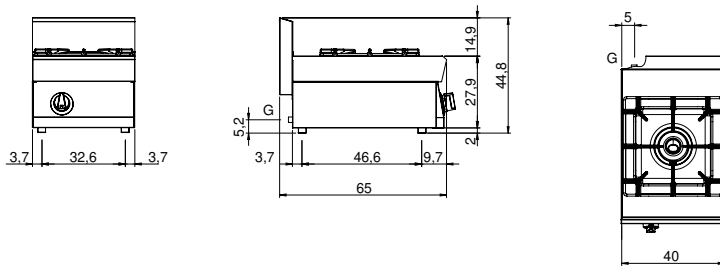

G: Gas connection 1/2"