



Client _____ Quantity _____
Project _____ Position _____

ROC 1100

Model: R110/100FTE/SLR/P

Cod: MP01375125024

Technical data

| | |
|-------------------------------------|-----------------------|
| Modularity: | On cabinet with doors |
| Dimension (mm): | 1000x1100x870 |
| Total electric power (kW): | 15 |
| Cooking zone dimensions 1 (LxD mm): | 734x900 |
| Electric power (V): | 380-415 |
| Ampere (A): | 11,5 |
| Phases: | 3N |
| Cable section (mmq): | 5G1,5 |
| Frequency (Hz): | 50-60 |
| Net volume (m3): | 0,957 |
| Packing dimensions (mm): | 1280x1272x1274 |
| Gross weight (kg): | 190 |
| Gross volume (m3): | 2,074 |

Features

| | |
|------------------------------|--|
| Working top: | Rrealizzato in acciaio inox AISI 304 spessore 2 mm |
| Material of plate: | Cromo satinato |
| Knobs: | Made of aluminum with IPX5 water protection |
| Handles: | The brushed aluminum handles allow for a secure and sturdy grip with a ergonomic lines |
| Flue: | Made of AISI 304 stainless steel |
| Heating: | Armoured heating elements |
| Liquid collection container: | Removable and dishwasher safe |
| Plate: | Satin chrome plate |
| Upright Splash guard: | On two sides (optional) |

Technical draw

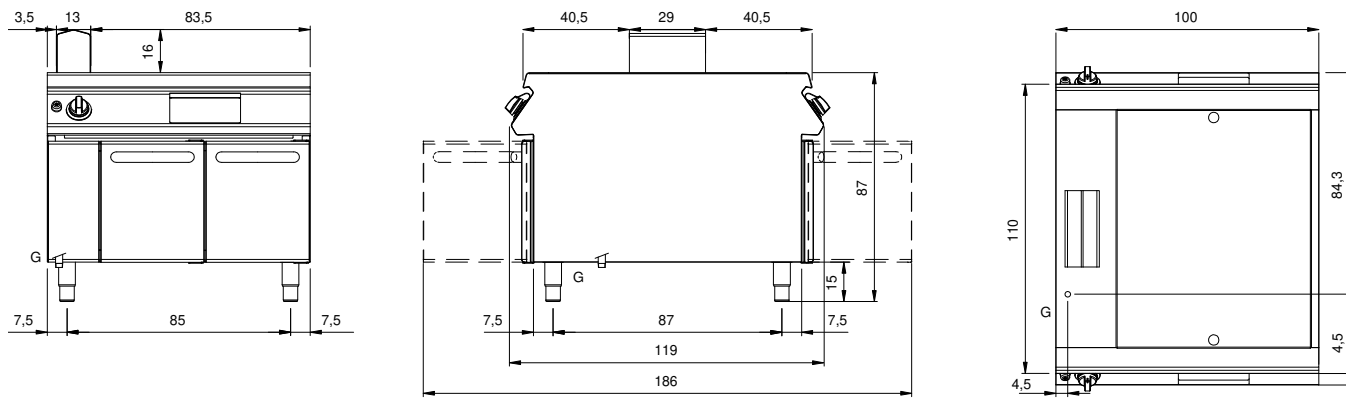

E: Electric power