

Client

Quantity

Project

Position

FUN 700

Model: F70/70FTE/SL/A

Cod: MP01372123035



Electric griddle with polished chromed grooved plate top version. Top made of AISI 304 stainless steel thickness 8/10; covering in AISI 304 stainless steel thickness 8/10; external reinforcements made of anti-corrosion material (aluminised sheet metal); bottoms and internal parts in AISI 430 steel; flue cover in enamelled steel. Chromed steel plate with high thermal conductivity for even temperature distribution. Equipped with front groove and pull-out drawer for collection of residual fats. Cooking zone equipped with 3 shielded heating elements which are thermostat controlled in a range of use from 50° to 300° C. Safety thermostat and indicator lights to show correct operation. - 3 plates x 1.5 kW - Total power 4.5 kW Cooking plate dimensions 395x550 mm. Electrical power supply VAC 400 + 3N 50÷60 Hz. Can be set up on "bridge system", or on neutral base with optional doors

## Technical draw

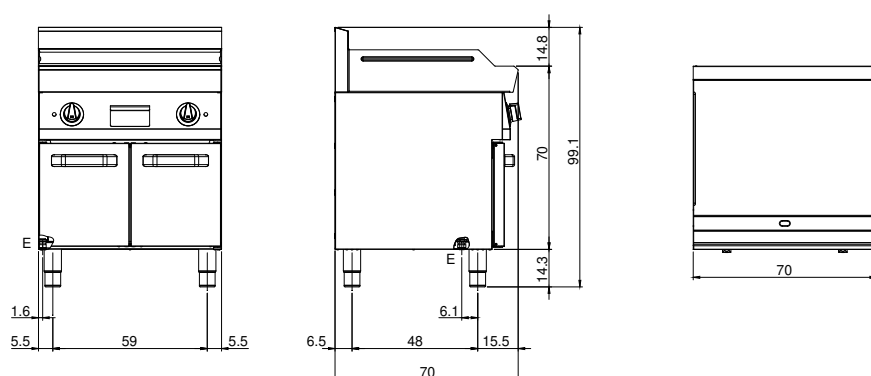

E: Electric power